

# HILTON LISLE/NAPERVILLE

## THE FACTS



Ranked among the top 10% of U.S. Hilton hotels for service and hospitality, Hilton Lisle/Naperville boasts beautifully appointed rooms and suites designed to pamper business and leisure travelers.

### AT A GLANCE

- Located off I-88 and Naperville Road in Chicago's corporate corridor
- Minutes from restaurants and shopping and 19 miles to O'Hare International Airport
- 18,000ft<sup>2</sup> of flexible event space, 309 guest rooms and suites
- Allgauer's award winning restaurant and catering
- 24 hour Business Center
- Indoor pool, whirlpool and Hilton Fitness by Precor®
- Complimentary shuttle within five mile radius





## EAT & DRINK

### ALLGAUER'S

Enjoy contemporary cuisine and impeccable service while taking in the beautiful view at the award winning Allgauer's Restaurant and Bar.

### THE BAR AT ALLGAUER'S

Enjoy our full menu with friends and business associates at the Bar at Allgauer's.

## MEETINGS

With 23 meeting rooms to accommodate 500 Guests, high speed internet access, 24 hour Business Center and a CMP certified staff, meetings at Hilton Lisle/Naperville have never been easier. The hotel was awarded Meetings MidAmerica Magazine's 2011 and 2010 best meeting hotel and venue award.

## OUR FACILITIES

### HILTON FITNESS BY PRECOR®

Personalized fitness for a balanced lifestyle while on the road. Outfitted with the latest generation of cardio and strength training equipment, Hilton Fitness by Precor® takes a personalized approach to help you feel your best during your stay.

### SWIMMING POOL

Relax in the refreshing waters of our beautiful indoor pool and whirlpool spa or enjoy our large outdoor sun deck.

### BUSINESS CENTER

Stay connected with the office or prepare for presentations at Hilton Lisle/Naperville's Business Center, which is furnished with up-to-the-minute technology including computers, printers, photocopiers, fax machine and wireless internet access. Additional services include courier and administrative assistance.

## OUR ROOMS

### GUEST ROOMS

Our luxurious guest rooms are beautifully decorated and elegantly appointed. Each guest room offers a 32-inch flat panel TV, Hilton Serenity Bed Package, Hilton alarm clock radio with MP3 connection, large work desk, two-line phones with voicemail, high speed internet, coffee maker, iron, ironing board and hair dryer.

### SUITES

Our splendidly appointed suites are ideal for planning small conferences and interviewing or hosting hospitality receptions. Parlors also have optional connecting guest rooms.

### EXECUTIVE ROOMS

Executive rooms are on a private, keyed access floor that has an attended lounge featuring computer and printing capabilities, complimentary weekday continental breakfast and evening hors d'oeuvres.

### ACCESSIBLE ROOMS

Our remodeled accessible guest rooms are beautifully decorated and comply with current ADA regulations.



## OUT & ABOUT

Within close proximity to the hotel, the Lisle/Naperville area offers a variety of things to see and do. Enjoy shopping at the outlet mall, stroll through Morton Arboretum, visit the Brookfield Zoo, Naper Settlement or the Cantigny Museum.



## LOCATION

The Hilton Lisle/Naperville hotel in Chicago's western suburbs is located 27 miles from downtown on I-88 at Naperville Road, between both Chicago O'Hare International and Midway Airports.



## LOWER CONFERENCE LEVEL

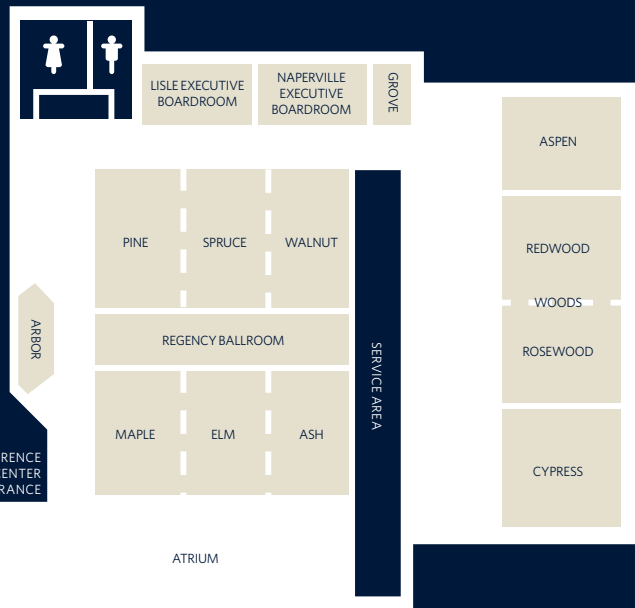

## LOBBY LEVEL

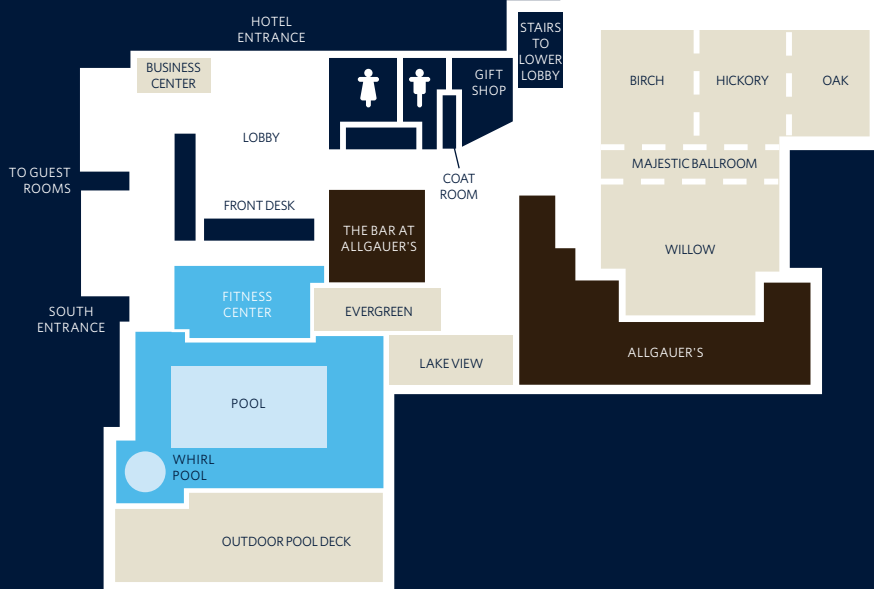

### KEY

- Food & Beverages
- Meeting/Conference Rooms
- Amenities

# CAPACITY CHART FOR CONFERENCE & EVENT ROOMS

## CAPACITIES & DIMENSIONS

LOBBY LEVEL	L x W x H	Square Footage	Banquet	Theater	Conference	Classroom	Reception	U-Shape	Hollow Square
Regency Ballroom	80' x 66' x 12'	5,280	480	700	—	400	600	—	—
Ash	32' x 22' x 12'	704	60	80	40	40	60	28	40
Elm	32' x 22' x 12'	704	60	80	40	40	60	28	40
Maple	32' x 22' x 12'	704	60	80	40	40	60	28	40
Pine	32' x 22' x 12'	704	60	80	40	40	60	28	40
Spruce	32' x 22' x 12'	704	60	80	40	40	60	28	40
Walnut	32' x 22' x 12'	704	60	80	40	40	60	28	40
Majestic Ballroom	62' x 72' x 11.5'	3,616	280	500	—	260	400	—	—
Birch	32' x 24' x 11.5'	768	50	70	34	40	60	28	34
Hickory	32' x 24' x 11.5'	768	60	80	40	40	60	28	40
Oak	32' x 24' x 11.5'	768	60	80	40	40	60	28	40
Willow	20' x 41' x 11.5'	820	80	90	42	60	80	36	42
Woods	56' x 34' x 11.5'	1,904	180	224	67	108	180	54	67
Redwood	28' x 34' x 11.5'	952	90	110	38	54	90	31	38
Rosewood	28' x 34' x 11.5'	952	90	110	38	54	90	31	38
Cypress	34' x 35' x 11.5'	1,190	100	156	48	78	100	35	48
Aspen	28' x 34' x 11.5'	952	90	110	38	54	90	31	38
Lisle Boardroom	17' x 28' x 10.5'	476	20	—	20	—	20	—	—
Naperville Boardroom	17' x 28' x 10.5'	476	20	—	20	—	20	—	—
<b>LOWER CONFERENCE LEVEL</b>									
Parlor East & West	25' x 72' x 8.5'	1,800	180	190	—	145	180	—	—
Parlor East	25' x 38' x 8.5'	950	90	100	42	80	90	35	42
Parlor West	25' x 34' x 8.5'	850	60	90	40	65	60	34	40
Conference Room I	22' x 23' x 8.5'	506	50	50	24	25	45	18	24
Conference Room II	22' x 23' x 8.5'	506	50	50	24	25	45	18	24
Conference Room III	24' x 23' x 8.5'	552	50	50	24	25	45	18	24
Conference Room IV	24' x 23' x 8.5'	552	50	50	24	25	45	18	24

HILTON LISLE/NAPERVILLE  
3003 Corporate West Drive | Lisle, IL 60532  
T: +1 630 505 0900 | F: +1 630 505 8948

[lislenaperville.hilton.com](http://lislenaperville.hilton.com)



AMERICAS • EUROPE • MIDDLE EAST • AFRICA • ASIA • AUSTRALASIA